

Recommended Tools

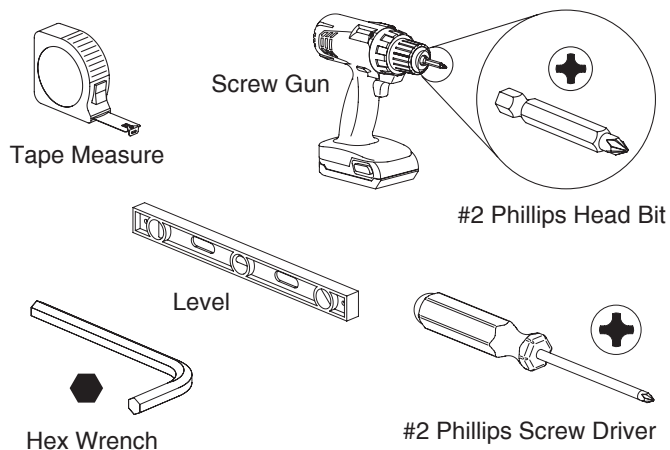

Adjustable Peninsula Desk Assembly

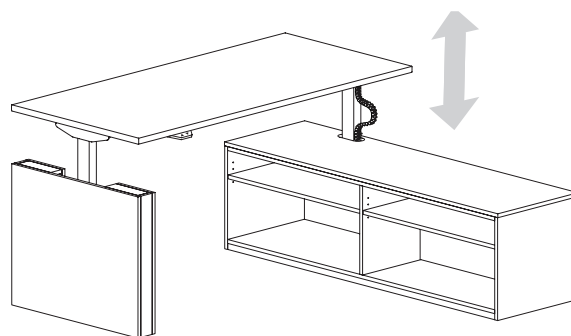

Hardware Used

#8 x 1 1/4" Flat Head Wood Screws

#8 x 3/4" Flat Head Wood Screws

#8 x 1 1/2" Flat Head Wood Screws

Package Contents

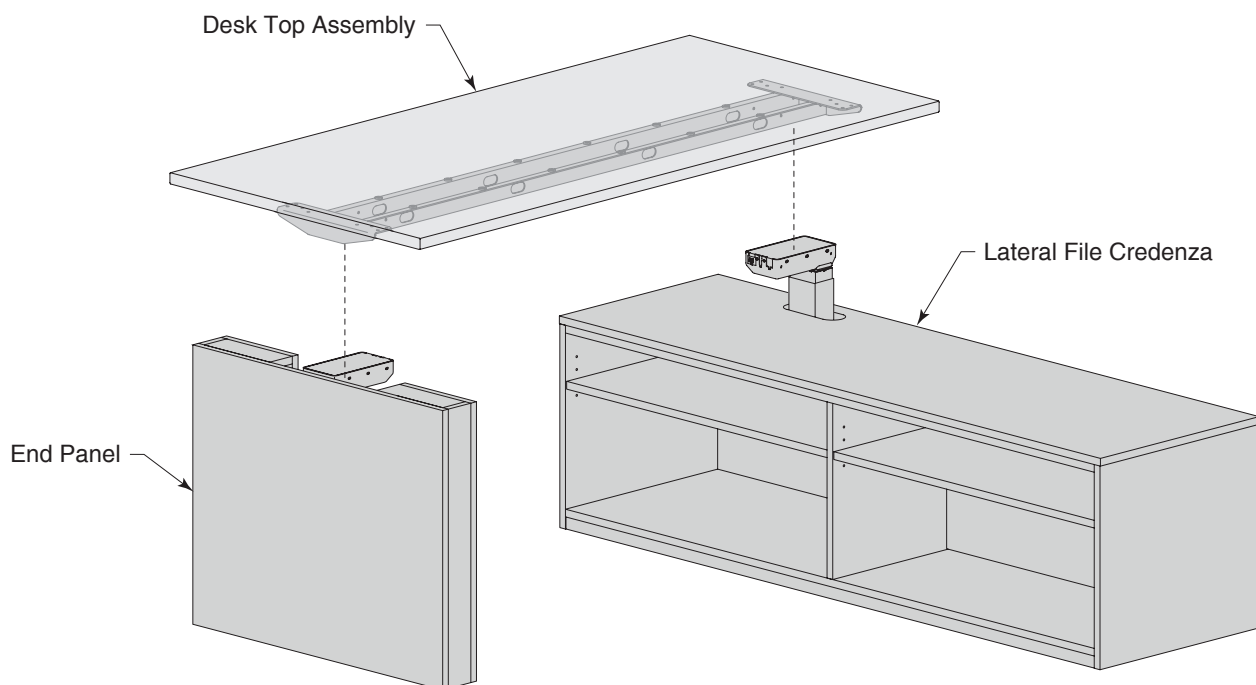

Notice To Installers: Failure to comply with installation instructions will compromise the safety, durability and performance of this product, which may risk injury to the user of this product and/or diminish the product life cycle. Jasper Group assumes no liability in these instances.

Step 1**Position and Level Units**

- Position adjustable desk panel base and credenza in desired location. The length of desk top will determine the spacing between panel base and credenza.
- Level units front-to-back and side-to-side by rotating adjustable glides.

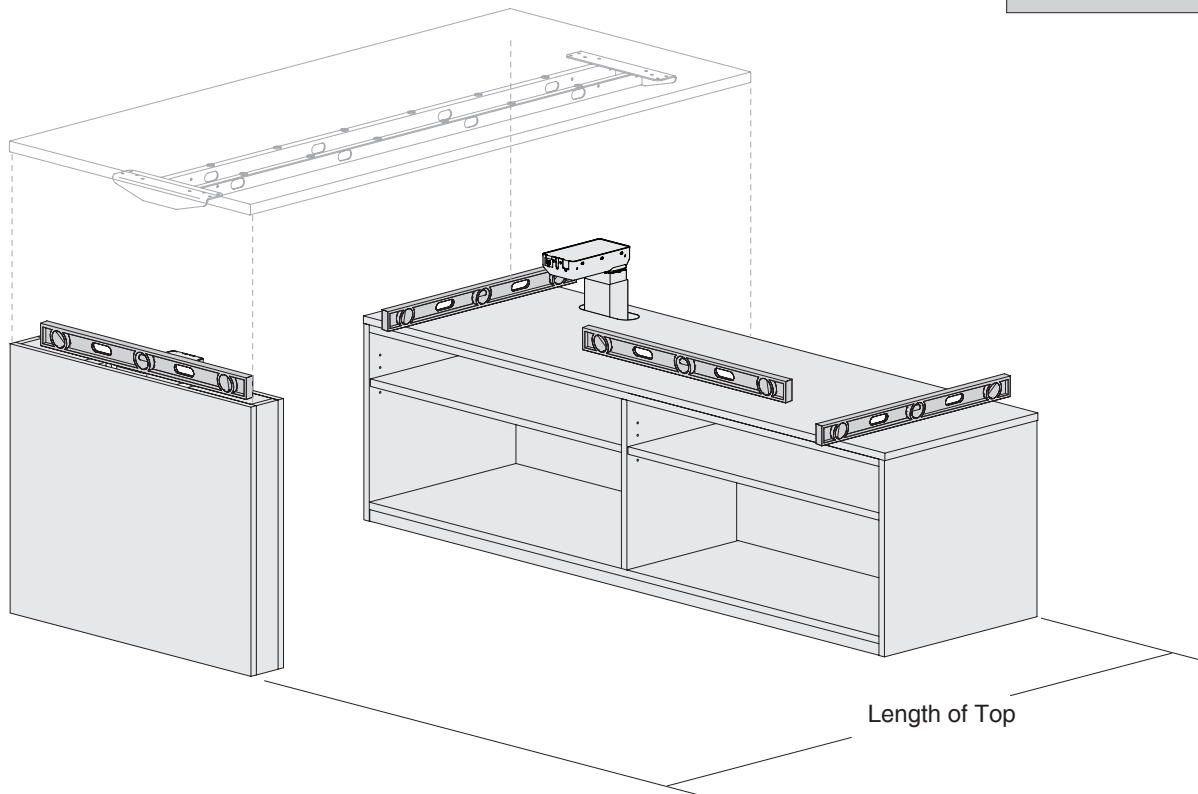
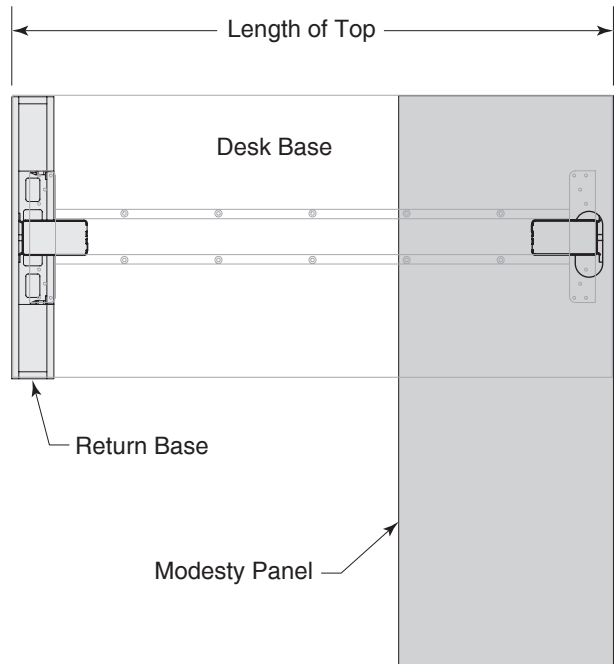
**Adjustable Peninsula Desk Assembly
(continued)****TOP VIEW**

Notice To Installers: Failure to comply with installation instructions will compromise the safety, durability and performance of this product, which may risk injury to the user of this product and/or diminish the product life cycle. Jasper Group assumes no liability in these instances.

Step 2

Attach Worksurface

Adjustable Peninsula Desk Assembly (continued)

- Carefully lower Desk Top Assembly into place

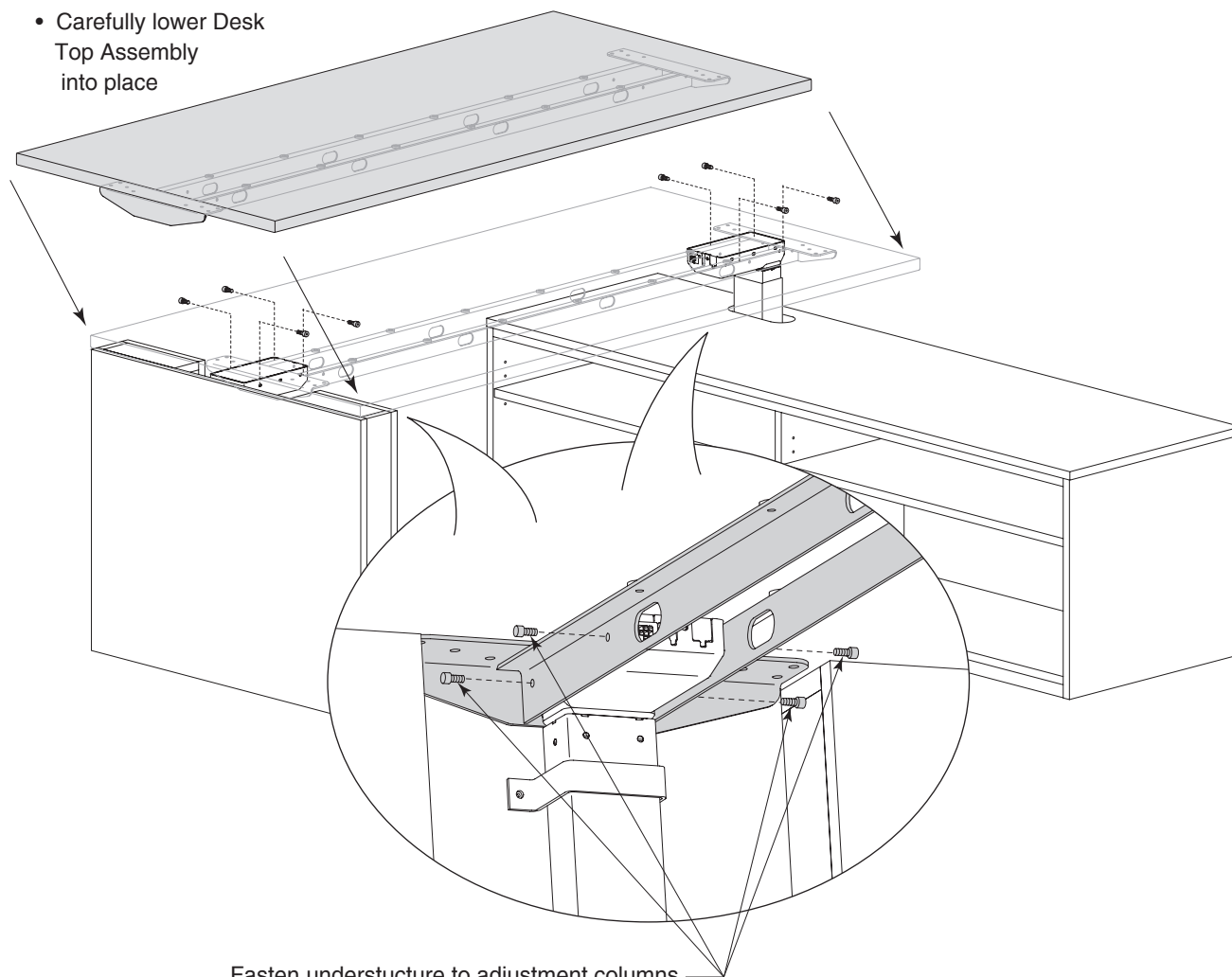

Fasten understructure to adjustment columns using eight (8) #6 X 12mm socket head bolts, four (4) per side.

Note: Hand tighten only. Do NOT secure firmly at this point.

Notice To Installers: Failure to comply with installation instructions will compromise the safety, durability and performance of this product, which may risk injury to the user of this product and/or diminish the product life cycle. Jasper Group assumes no liability in these instances.

Step 3

Connect Electrical Wiring

Adjustable Peninsula Desk Assembly (continued)

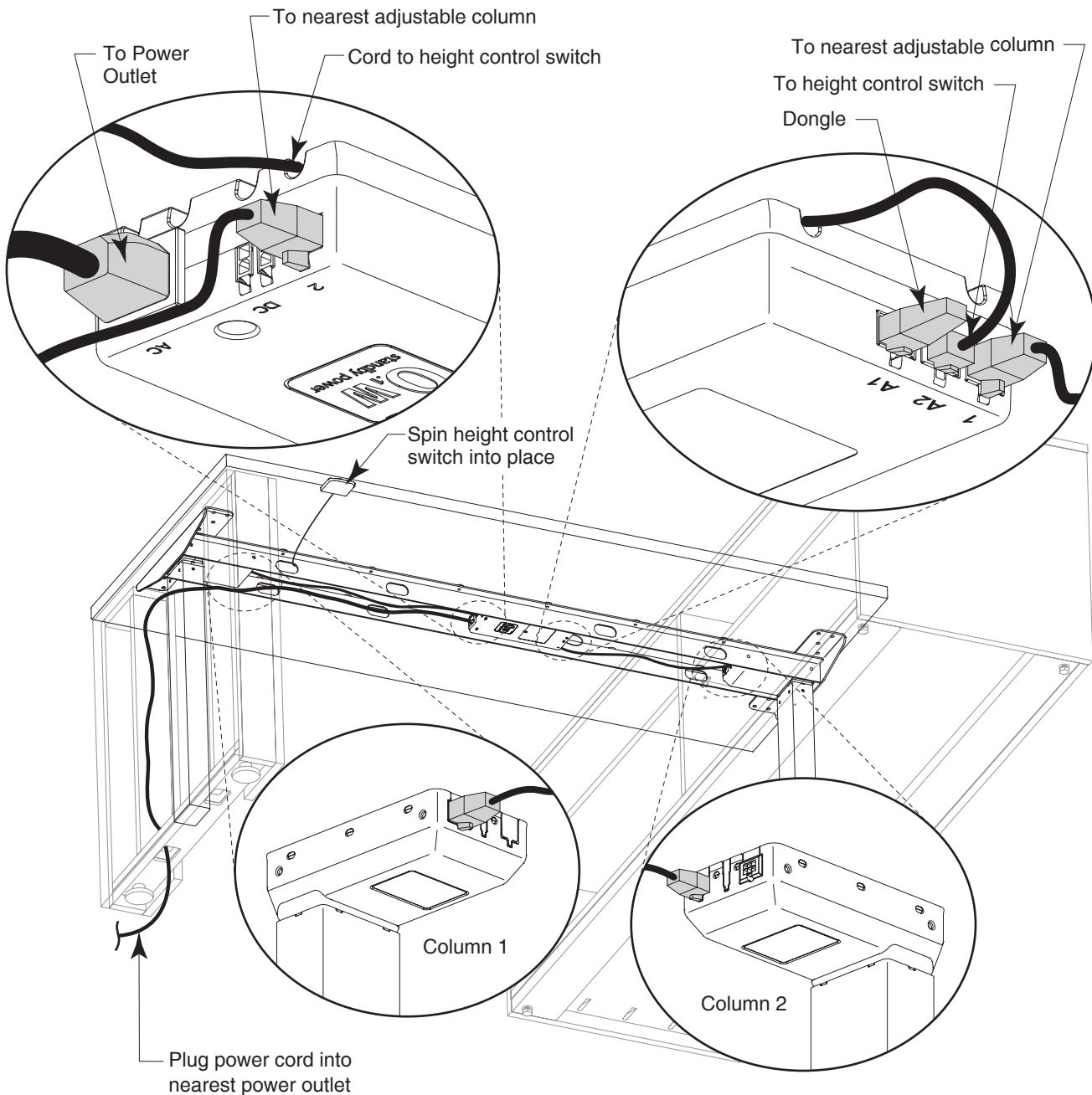

Notice To Installers: Failure to comply with installation instructions will compromise the safety, durability and performance of this product, which may risk injury to the user of this product and/or diminish the product life cycle. Jasper Group assumes no liability in these instances.

Step 4

Secure Worksurface To
Adjustable Height Columns

Adjustable Peninsula Desk Assembly (continued)

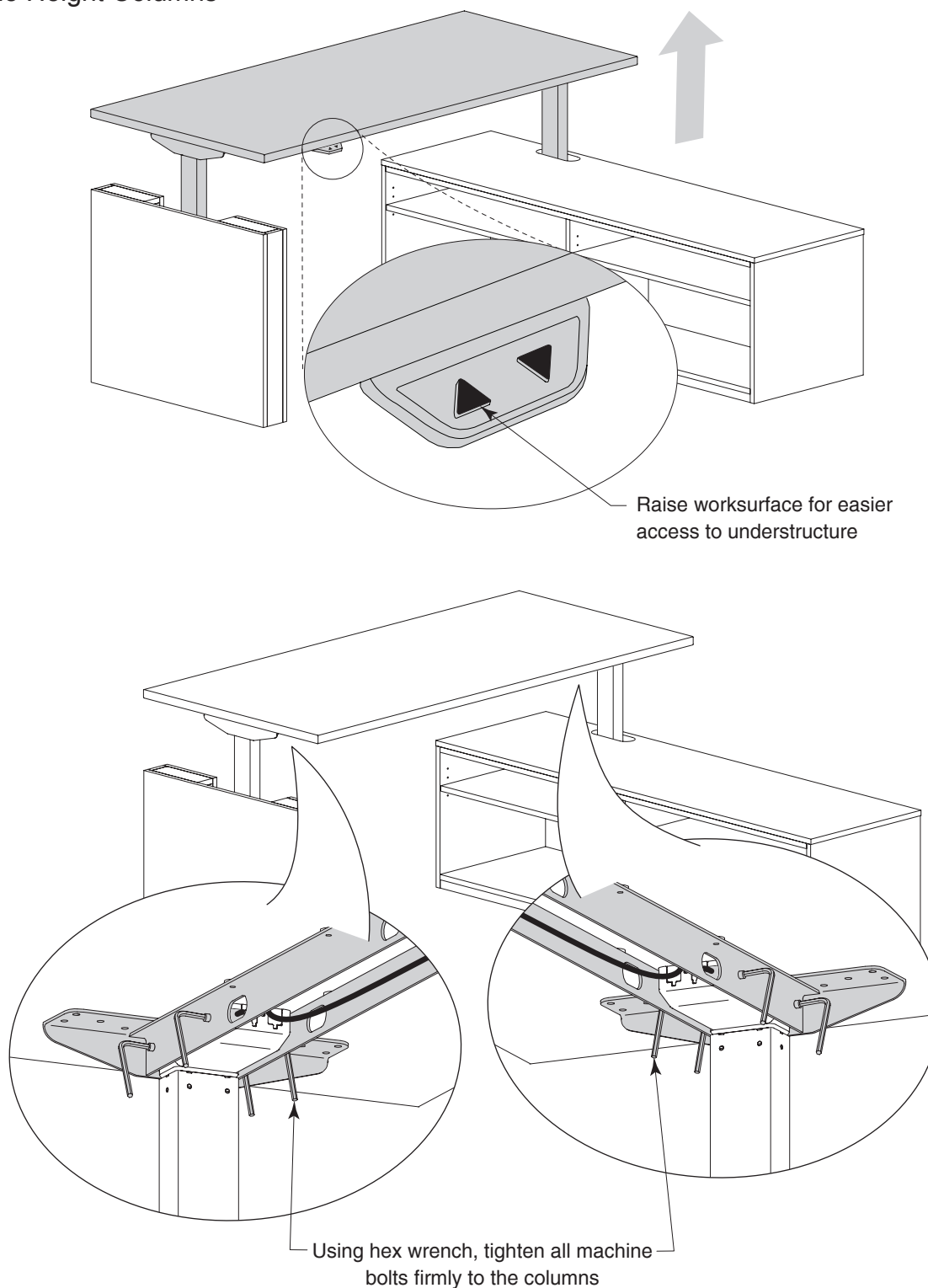

Notice To Installers: Failure to comply with installation instructions will compromise the safety, durability and performance of this product, which may risk injury to the user of this product and/or diminish the product life cycle. Jasper Group assumes no liability in these instances.

Step 5

Attach Wire Manager
(Optional)

Adjustable Peninsula Desk Assembly (continued)

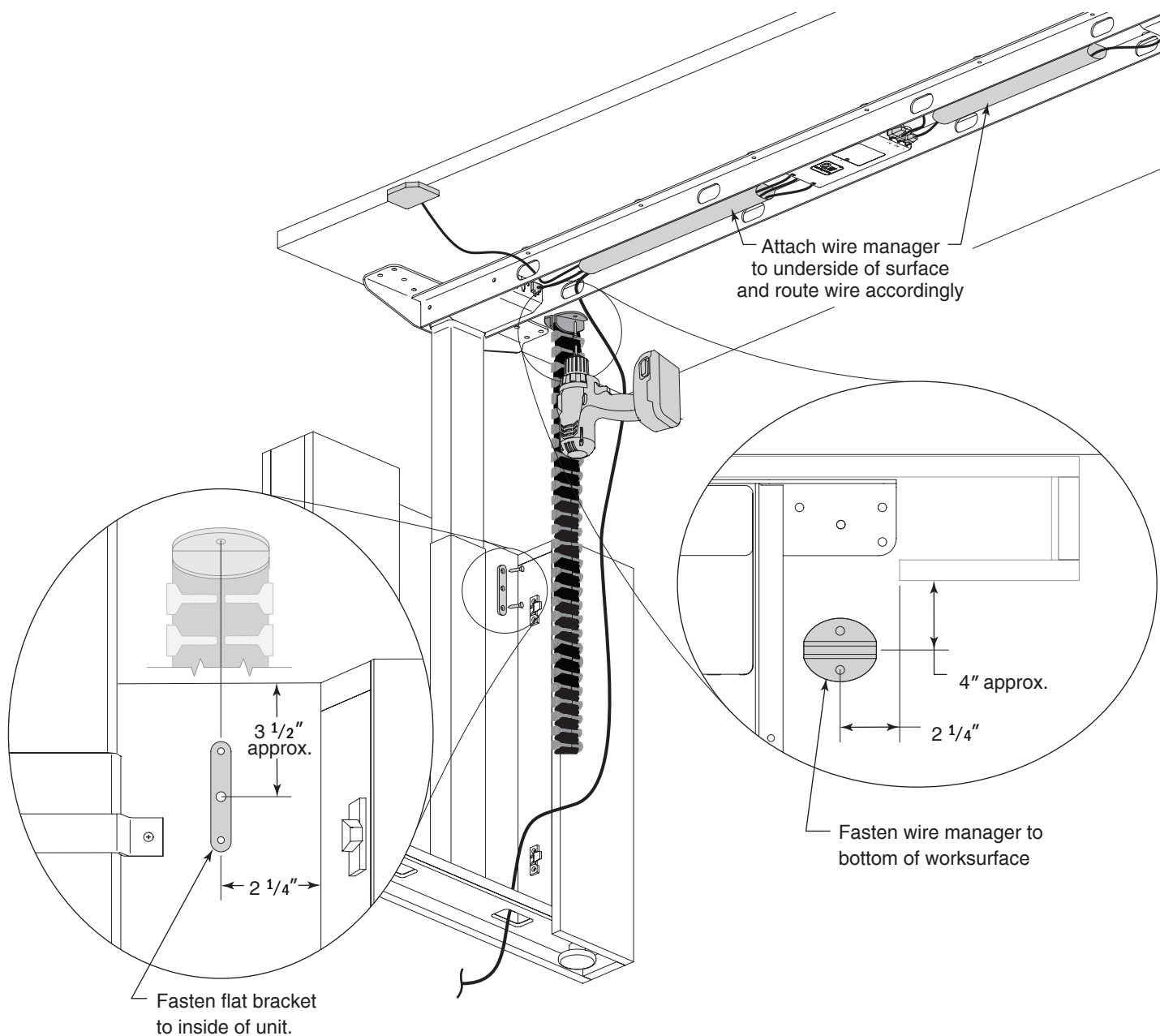

Notice To Installers: Failure to comply with installation instructions will compromise the safety, durability and performance of this product, which may risk injury to the user of this product and/or diminish the product life cycle. Jasper Group assumes no liability in these instances.

Step 6

Route Power Cord
Through Wire Manager

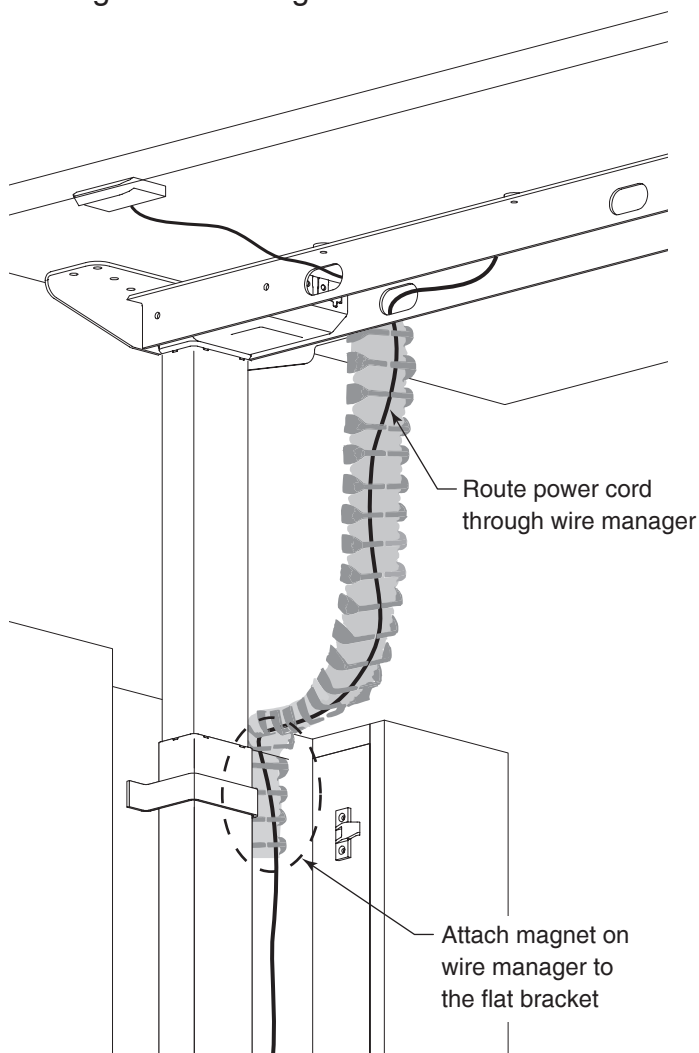
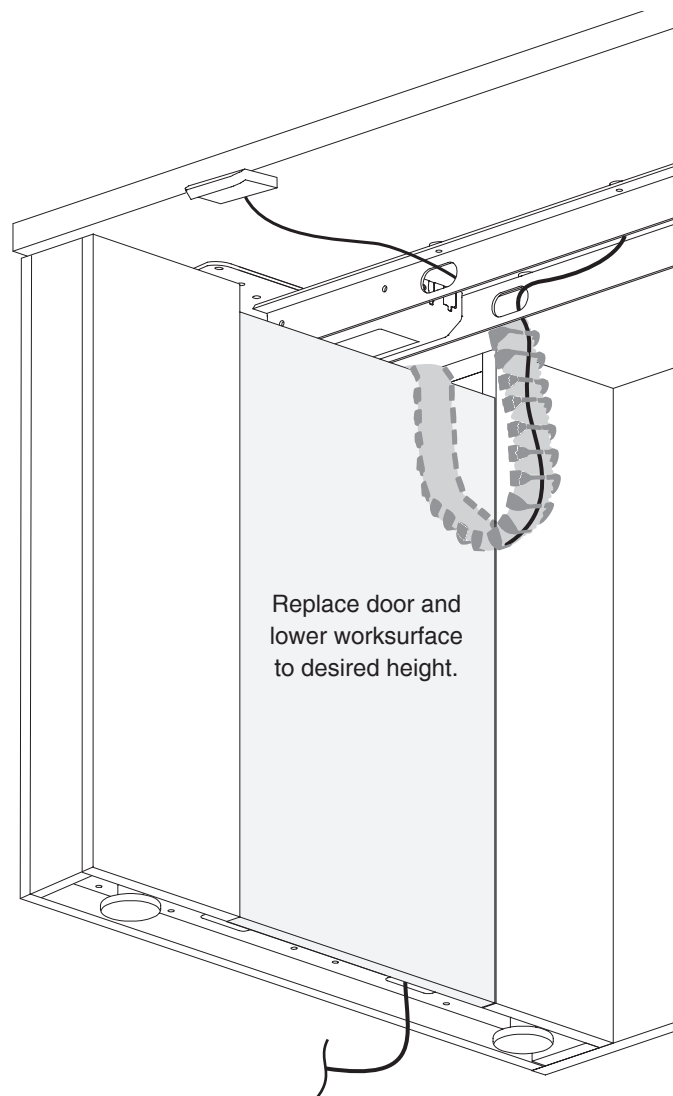
**Adjustable Peninsula Desk Assembly
(continued)**

Notice To Installers: Failure to comply with installation instructions will compromise the safety, durability and performance of this product, which may risk injury to the user of this product and/or diminish the product life cycle. Jasper Group assumes no liability in these instances.

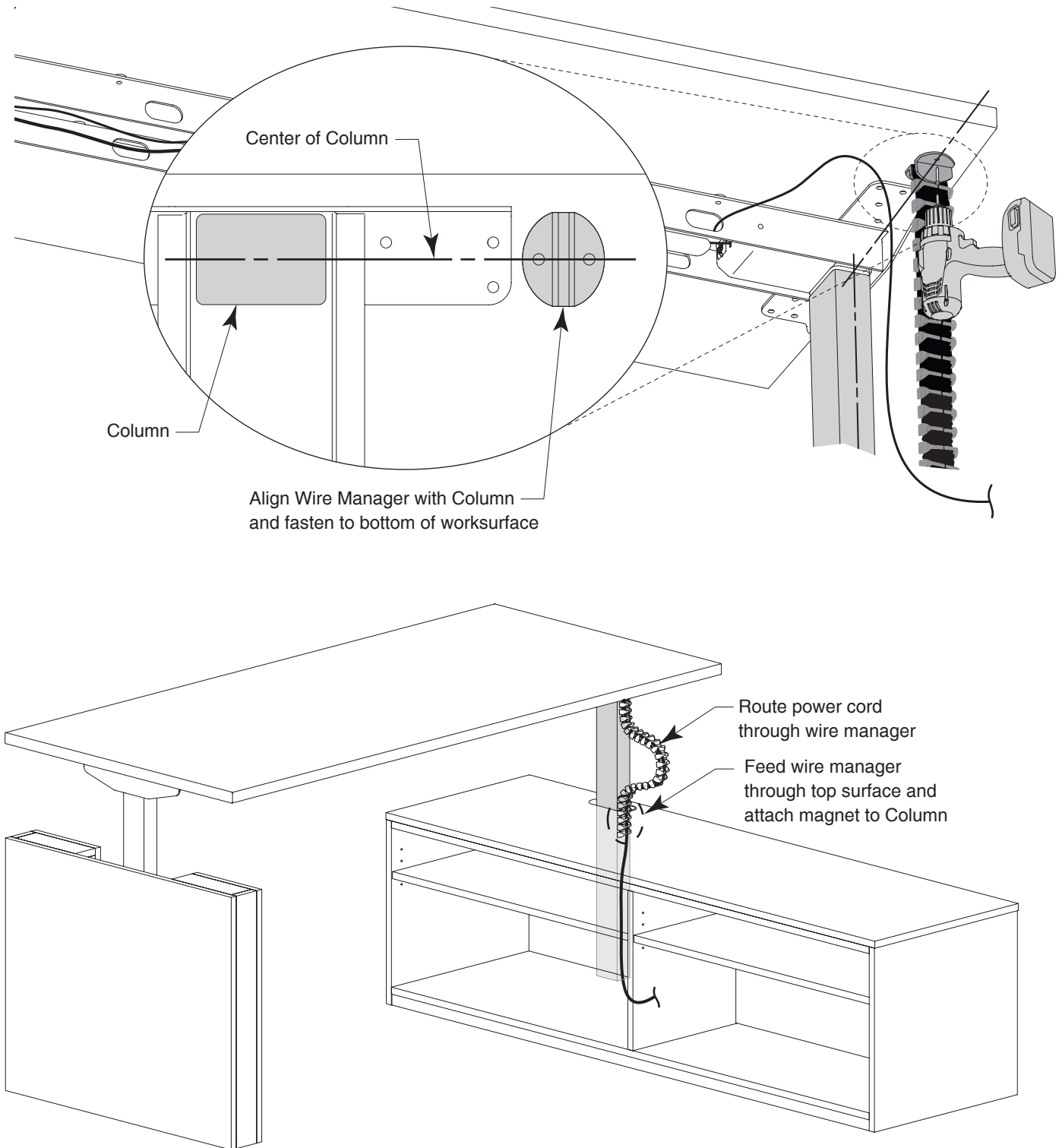
Step 7**Alternate Wire Manager Attachment
(Optional)****Adjustable Peninsula Desk Assembly
(continued)**

Notice To Installers: Failure to comply with installation instructions will compromise the safety, durability and performance of this product, which may risk injury to the user of this product and/or diminish the product life cycle. Jasper Group assumes no liability in these instances.